

## EcoFlow GLACIER

---

EcoFlow GLACIER is the world's first 3-in-1 portable fridge, freezer, and ice maker. Enjoy ice-cold drinks and fresh food when you're on the road, boat, truck, camping, or off-grid.



**"The Best Portable Appliance "**

By Popular Mechanics



---

### Follow Us:

Facebook/Twitter/Instagram:  
@ecoflowtech

### Contact Us:

Web: [ecoflow.com](http://ecoflow.com)  
Email: [sales.rest@ecoflow.com](mailto:sales.rest@ecoflow.com)

# GLACIER

**Get Chillin. Get Movin.**



## EcoFlow Introduction

---

EcoFlow is a leading company in eco-friendly energy solutions with the vision to power a new world. Since its founding in 2017, EcoFlow has become a reliable and trusted energy companion for individuals and families across the world, providing accessible and renewable power solutions for homes, outdoors, and off-grid living. Today, with operational headquarters located in the USA, Germany, and Japan, EcoFlow has empowered more than 2 million users in over 100 regions worldwide.



## Cooling for up to 40 hours wire-free

Designed for absolute portability, GLACIER can be powered by the Plug-in Battery and free from messy, limiting cables. With a large battery capacity of 298Wh, savor up to 40 hours. With 100W max USB-C charging, it even powers up your phones and laptops.



## A fridge-freezer at its best

Equipped with a removable divider separating it into two zones, and independent temperature control, both sections can refrigerate and freeze from 50°F (10°C) to -13°F (-25°C). whatever you want to stock up on, it shape-shifts to meet your needs.



\*Cooling at the optimum speed when empty

## Industry's first integrated ice maker

Equipped with a powerful 120W compressor, it brings you 18 solid ice cubes in 12 minutes. For all the spine-tingling moments along your journey, spice them up with chilled sodas.

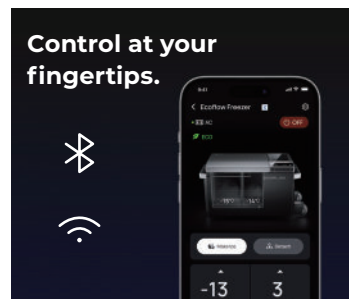

## Scenarios



## Specification

### General information

**Net Weight**  
23 kg (50.7 lb)

**Dimensions (wheels and handles not included)**  
776 mm × 385 mm × 445 mm (30.6 in. × 15.2 in. × 17.5 in.)

**IP Rating**  
IPX4

**App Control**  
Bluetooth, Wi-Fi

**Refrigeration Temperature Range**  
10°C (50°F) to -25°C (-13°F) (ambient temperature at 25°C)

**Noise Level (stable operation)**  
Ice making: <52 dB; Refrigeration: <42 dB

**Refrigerant type/Amount**  
R600a, 32 g

**Quick Freezing Mode**  
Refrigerate from 30°C (86°F) to 0°C (32°F) in 15 minutes

**Refrigeration Power Rating**  
120W

### Input

**AC Input**  
100-240V, 50/60Hz, 180W

**Car Charging Input**  
192W (12/24V, 8A Max)

**Solar Charging Input**  
240W (11-60V, 13A Max)

**Battery Pack Power**  
100W (USB-C)

### Operating temperatures

**Optimal Operating Temperature**  
-20°C (-4°F) to 50°C (122°F)

**Optimal Storage Temperature**  
-10°C (14°F) to 60°C (140°F)

### EcoFlow GLACIER Plug-in Battery

**Net weight**  
1.8 kg (4 lb)

**Dimensions**  
245.5 mm × 92 mm × 68 mm  
(9.7 in. × 3.6 in. × 2.7 in.)

**Cycle life**  
800 cycles to 80%

**Capacity**  
298Wh